

Please take these steps to set up your Gateway

altafiber

1 Locate the Fioptics Wiring



Your Fioptics wiring should already be installed at your residence. The data jack is typically labeled and may be near the TV, or in the home office. It will have a blue or orange port. It's important not to confuse the data jack with a standard telephone jack.

Alternatively, you can connect directly to your ONT. Your ONT is typically located in the basement or a garage. If you don't find it easily, you can look on the outside of your house and find where the black fiber cable enters your home. Many times, you'll find the ONT on the other side of the wall, or close by. Ensure your ONT is plugged in and the power indicator is lit.

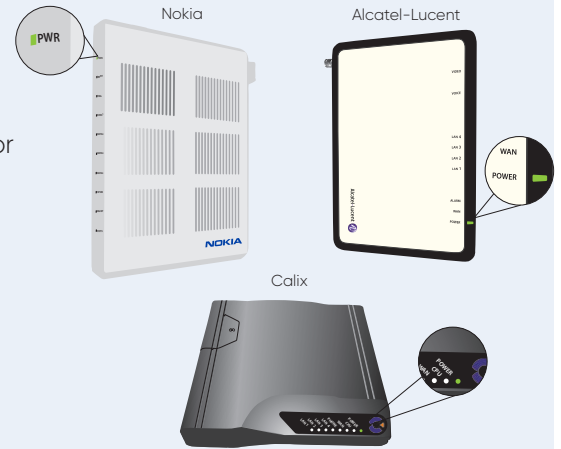

2 Connect the Gateway

Once you've located the data jack or ONT, you are ready to connect the equipment. Start by plugging one end of the provided Ethernet cable into the blue WAN port on your Gateway. Plug the other end into the data jack, or into port 1 on the ONT. Make sure the ONT is plugged in and powered on.

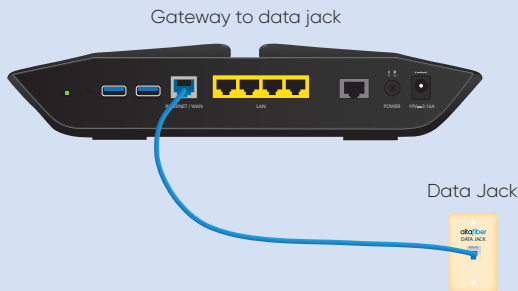

OR

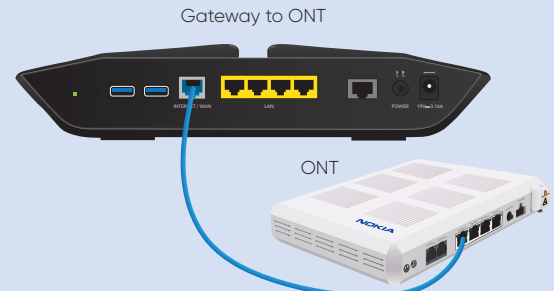

3 Power It Up

Now it's time to power up the equipment. Plug the power adapter into a nearby wall outlet and connect it to the power port of your Gateway.

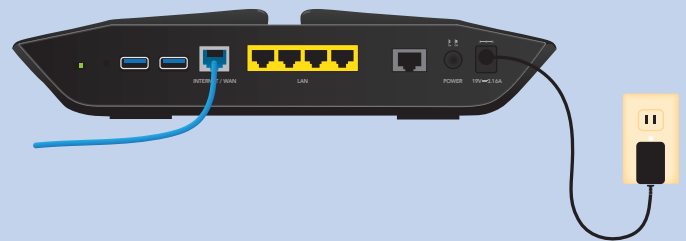

We're here for you.

We are here to help and want you to be completely satisfied with your Fioptics service. Please scan this code for self-help tips, troubleshooting, support videos and more.



If you need further assistance, please visit altafiber.com/support, via SMS at **513.301.2093** or call us at **513.565.9890**.



My altafiber

Free online access is available round-the-clock, which makes reviewing and updating your account information fast, secure and easy. Plus, you'll find a wealth of support information and online tours to guide you. To sign up, go online to altafiber.com and click on **My altafiber**.

Pay bills • Find your closest store
Ask questions • Receive special offers

